

- DC to 40 GHz
- Mechanically Compatible with SMA, 3.5 mm Connectors

- Air Dielectric
- Captivated Center Contact

► JACK (Female)

Unit : mm [Inch]

Panel Mount (2 HOLE, 15.9 mm LONG)	Panel Mount (2 HOLE, 13.9 mm LONG)
<ul style="list-style-type: none"> • Part No. PKF-S00-000 (G02SFA001) • Accept Pin DIA. 0.30 [0.012] • Gigalane Accept pin P/N : TL-522 	<ul style="list-style-type: none"> • Part No. PKF-S01-000 (G01SMA002) • Accept Pin DIA. 0.30 [0.012] • Gigalane Accept pin P/N : TL-522
Panel Mount (4 HOLE, 12.8 mm SQUARE)	Panel Mount (4 HOLE, 9.5 mm SQUARE)
<ul style="list-style-type: none"> • Part No. PKF-S02-000 (G01SMA003) • Accept Pin DIA. 0.30 [0.012] • Gigalane Accept pin P/N : TL-522 	<ul style="list-style-type: none"> • Part No. PKF-S03-000 (G01SMA004) • Accept Pin DIA. 0.30 [0.012] • Gigalane Accept pin P/N : TL-522

► PLUG (Male)

Unit : mm [Inch]

Panel Mount (2 HOLE, 15.9 mm LONG)	Panel Mount (2 HOLE, 13.9 mm LONG)
<ul style="list-style-type: none"> • Part No. PKM-S00-000 (G02SMA001) • Accept Pin DIA. 0.30 [0.012] • Gigalane Accept pin P/N : TL-522 	<ul style="list-style-type: none"> • Part No. PKM-S01-000 (G02SMA002) • Accept Pin DIA. 0.30 [0.012] • Gigalane Accept pin P/N : TL-522
Panel Mount (4 HOLE, 12.8 mm SQUARE)	Panel Mount (4 HOLE, 9.5 mm SQUARE)
<ul style="list-style-type: none"> • Part No. PKM-S02-000 (G02SMA003) • Accept Pin DIA. 0.30 [0.012] • Gigalane Accept pin P/N : TL-522 	<ul style="list-style-type: none"> • Part No. PKM-S03-000 (G02SMA005) • Accept Pin DIA. 0.30 [0.012] • Gigalane Accept pin P/N : TL-522

RF & MW Connectors

RF & MW Adapters

RF Connectivity Test Solutions

Test & Measurement

Cable Assemblies

Appendix

Test Result of 2.4mm & 2.92mm Connectors

► Design Guide (Microstrip to coax)

A very reliable connector can still increase VSWR if it does not match impedance when it is connected. Therefore, 50ohm microstrip line structure is recommended to get a maximized future advantage with PKF series connector.

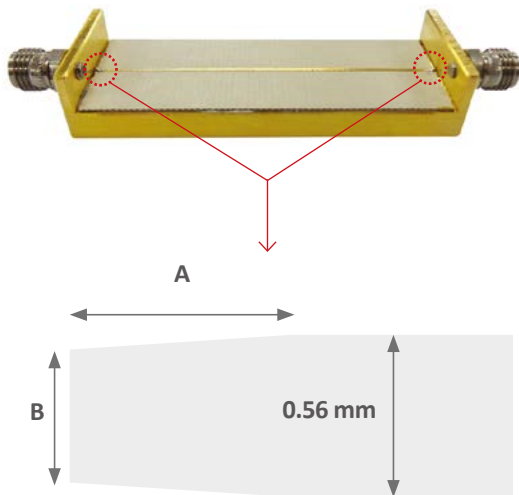

	t	w	g
Er 2.2	10 mil	0.56 mm	0.1 mm

	Tapper 1	Tapper 2	Tapper 3
A	1.0 mm	2.0 mm	3.0 mm
B	0.53 mm	0.5 mm	0.45 mm

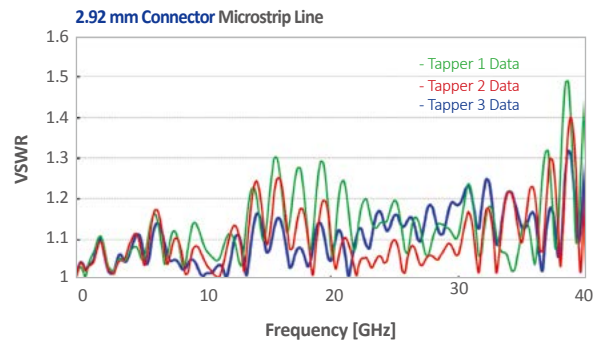

► Test result of Back to Back

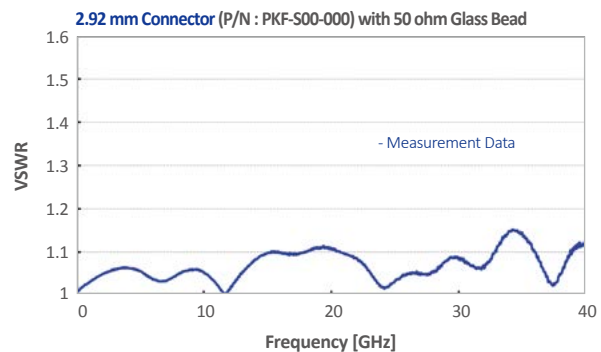
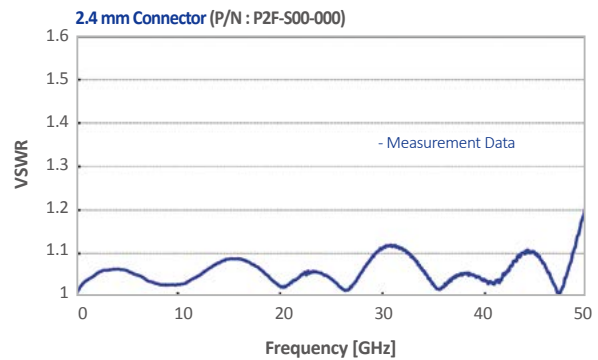

0.012" Glass Bead Installation

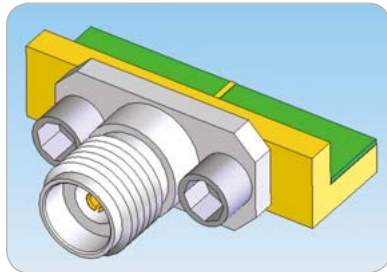
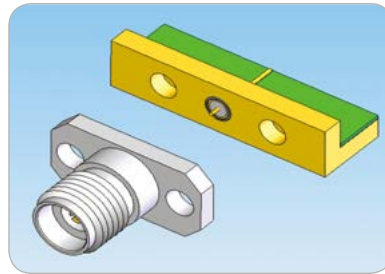
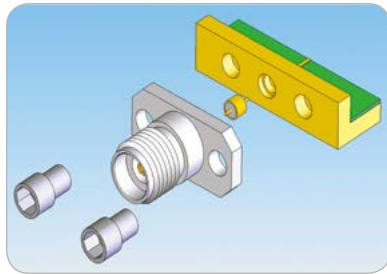
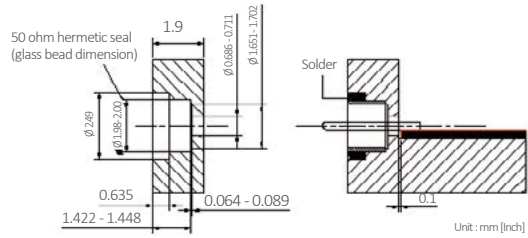
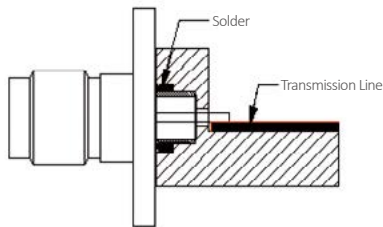

► Hermetic Seal (0.012" Glass Bead)

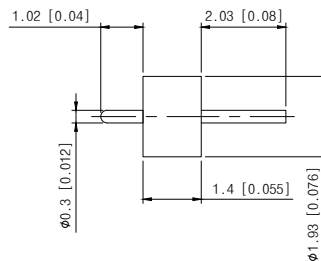
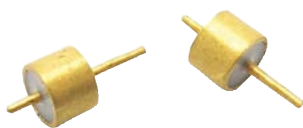

• Part No. TL-522